



Euromecc S.r.l.

SS 192 Km 79 - Casella Postale 163
95045 Misterbianco (CT) - Italia
C. Fiscale e P. IVA 02671040877

Tel. +39 095 713 00 11
Mob. +39 331 183 47 41 +39 331 183 47 43
Fax +39 095 713 01 15
<http://www.euromecc.com>
e-mail: sales@euromecc.com

Direct contacts:

-  +39 335 715 67 77
-  +39 335 732 09 49
-  +39 335 715 19 19
-  +39 335 679 27 71
-  +39 342 543 93 31
-  +49 172 463 27 00

sales@euromecc.com



1



2



3

(1) Mescolatore planetario da 0,5 a 2,5 m³ di resa vibrata
Planetary Mixer from 0,5 to 2,5 m³ concrete output production

(2) Sensore rotante di umidità e di temperatura a microonde
Moisture sensor for planetary mixer

(3) Vagonetto aereo per trasporto calcestruzzo
Air cabin for concrete transport



EURO 4 V/E DRY

UNITS	A	B	C	D	E	F	G
METRIC (mm)	21300	9100	4420	12800	3200	4200	6500
UNITED STATES (ft. - in.)	69' 11"	29' 10"	14' 6"	42'	10' 6"	13' 9"	21' 4"

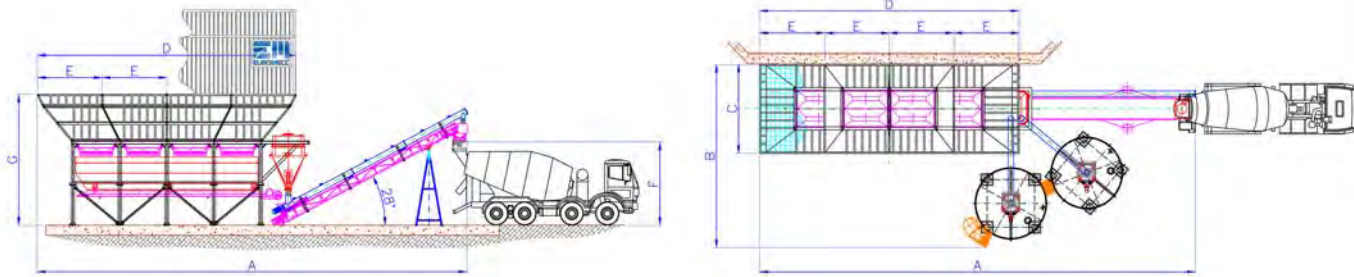

EURO 5 V/E DRY

UNITS	A	B	C	D	E	F	G
METRIC (mm)	16100	17750	4420	16000	3200	11800	7800
UNITED STATES (ft. - in.)	52' 10"	58' 3"	14' 6"	52' 6"	10' 6"	38' 9"	25' 7"

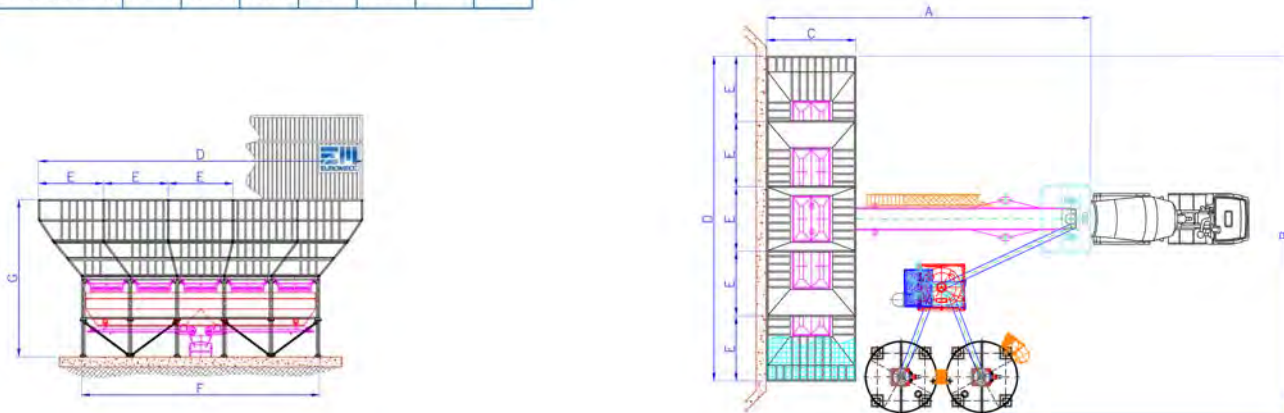

EURO 6 V/E DRY

UNITS	A	B	C	D	E	F	G
METRIC (mm)	16100	18700	4420	18000	3000	11800	8400
UNITED STATES (ft. - in.)	52' 10"	61' 4"	14' 6"	59' 1"	9' 10"	38' 9"	27' 7"

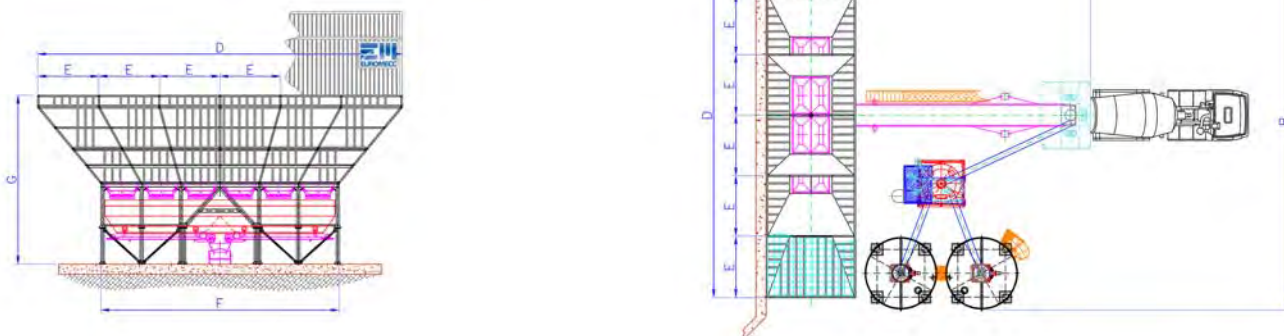

Vista laterale

Lateral view

UNITS	A	B	C	D
METRIC (mm)	16100	4420	3500	4200
UNITED STATES (ft. - in.)	52' 10"	14' 6"	11' 6"	13' 9"

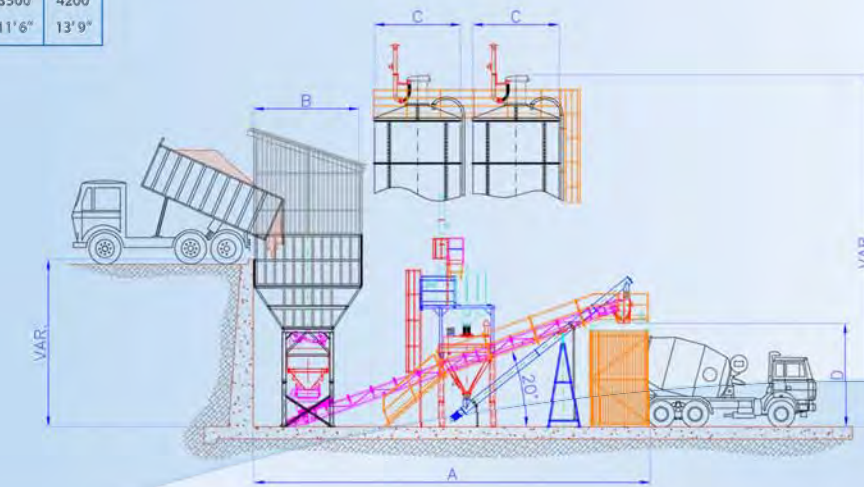

CARATTERISTICHE TECNICHE / TECHNICAL FEATURES*	METRIC UNITS				UNITED STATES UNITS			
	um	euro 4 V/E	euro 5 V/E	euro 6 V/E	um	euro 4 V/E	euro 5 V/E	euro 6 V/E
• produzione oraria max - max. hourly output	m³/h	80	80	80	yd³/h	105	105	105
• stoccaggio inerti geometrico - aggregate storage real geometric volume	m³	65/125	115/150	220*	yd³	85/163	150/196	288*
• stoccaggio inerti a colmo - aggregate storage at full capacity	m³	95/180	150/220	260*	yd³	124/235	196/288	340*
• vasche inerti - aggregate storage bins	n°	4	5	6	n°	4	5	6
• bocchette/cilindri pneumatici - discharge gates/pneumatic cylinders	n°	8/4	10/5	12/6	n°	8/4	10/5	12/6
• tramoggia pesa inerti - aggregate weighing hopper	m³	18**	18	18	yd³	24**	24	24
• sistema di pesatura inerti - aggregate weighing system	kg	20000	20000	20000	lb	44,092	44,092	44,092
• tramoggia pesa cemento - cement weighing hopper	m³	5	5	5	yd³	6.5	6.5	6.5
• sistema di pesatura cemento - cement weighing system	kg	5000	5000	5000	lb	11,023	11,023	11,023
• dosaggio acqua con lancia impulsi elettromeccanico - water batching with electromechanical pulse emitter	∅	2"	2"	2"	∅	2"	2"	2"
• nastro estrattore telo 800 mm - extractor belt with sheet 800 mm	m³/h	90÷180	90÷180	90÷180	yd³/h	118÷235	118÷235	118÷235
• nastro caricatore telo 800 mm - conveyor belt with sheet 800 mm	m³/h	180	180	180	yd³/h	235	235	235
• coclea di carico ø273 mm - loading screw diameter Ø 273 mm	t/h	60	60	60	lb/s	33	33	33
• compressore - air compressor	L	270/500***	270/500***	270/500***	gal	71/132***	71/132***	71/132***
• tensione d'esercizio - operating voltage	V	400	400	400	V	460	460	460
• frequenza d'esercizio - operating frequency	Hz	50	50	50	Hz	60	60	60
• potenza elettrica installata - installed electrical power	hp/kW	68/50	68/50	68/50	hp/kW	68/50	68/50	68/50

* versione unica - only version / ** con spondine - with small side panels / *** in presenza di cappa d'aspirazione - with suction hood

ACCESSORI OPZIONALI - OPTIONAL ACCESSORIES

- Struttura portante in acciaio - Steel structure to avoid concrete structure
- Secondo livello di sponde - Second side panels level
- Copertura gruppo vasche - Covering of aggregate bins
- Sistemi di pesatura inerti da kg 25000 per dosaggio da 12 m³ - 55000 lb aggregate weighing system for batching 15.7 yd³
- Rivestimenti anti-usura per bocchette e dosatori inerti - Anti-wear lining for aggregate batching gates and aggregate hopper
- Coclee trasporto cemento - Cement screw conveyor
- Dosatori additivi - Concrete additive batchers
- Misuratori di umidità inerti - Aggregate dampness counters
- Predisposizione per impianto di riscaldamento inerti - Prearrangement for heating equipment
- Dispositivi per aggiunta ghiaccio all'impasto - Devices for the addition of ice into the mixture



Le informazioni e i dati sono da ritenersi puramente indicativi
All information and data indicated shall be deemed purely indicative